

Traffic Plan – Banksmeadow Recycling

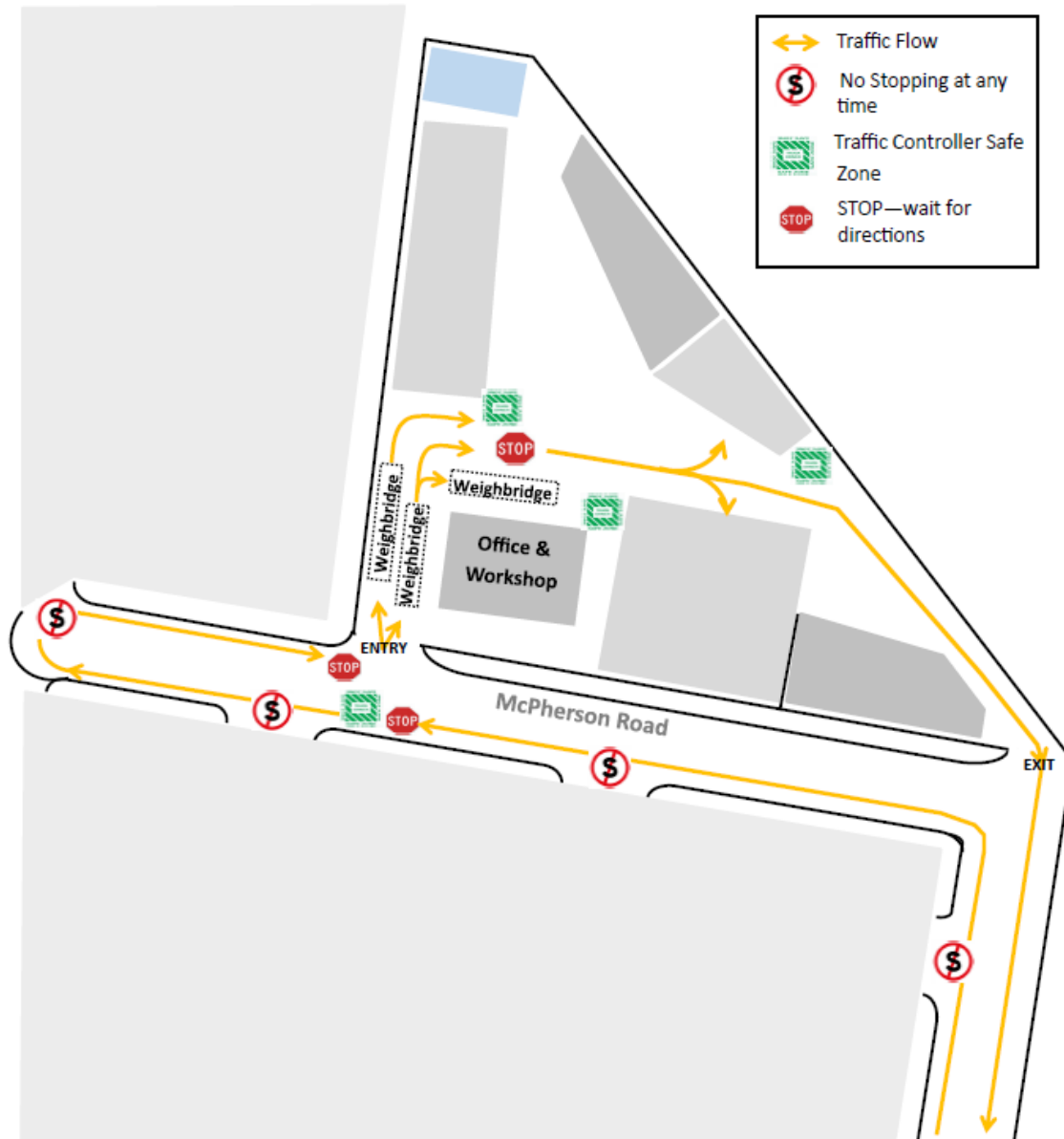

Site access and traffic controls

NSW road rules apply on site with the exception of the following:

- The instructions of the site staff and site signage are to be complied with and followed at all times
- No traffic can block driveways in McPherson street
- All vehicles with two way radios are to tune them to site channel and await instructions
- All vehicles entering or leaving site must proceed with caution in a forwards direction – outbound vehicles have right of way
- The speed limit is 5km/h
- Unloading and un-tarping are to take place in designated areas on site as instructed by the traffic controller
- PPE is required in all areas except the car park
- Pedestrians, including visitors, have restricted access and must be under the supervision of allocated site staff at all times
- An exclusion zone of 3 metres applies around all mobile equipment
- Drivers are responsible for ensuring all beacons and reversing alarms are operational at all times
- Where traffic aids, such as mirrors and speed humps, are provided, they are to be used with caution
- Entry into exclusion zones is only permitted following approval from the site supervisor or traffic controller
- No vehicle is to enter a traffic controller or driver safe zone
- Vehicles must ensure no tracking of mud or other waste is on tyres when leaving site

Site procedures

- Trucks entering site must proceed towards the weigh bridge but cannot queue on the weigh bridge
- Drivers must provide all required details to the weigh bridge officer either by radio or at the weigh bridge office
- The weigh bridge officer records all details, inducts the driver if required and provides PPE if needed
- The weigh bridge officer will radio site staff to seek instructions
- Trucks proceed to queuing area to un-tarp, stopping where indicated by signage or the traffic controller
- While waiting, trucks are to keep left and queue as directed by the traffic controller
- There is no queuing on the tip floor – drivers must await instructions from tip floor staff to proceed
- Trucks must reverse to the tip floor – reversing requires a tip-floor staff to act as a spotter
- Tip floor staff inspect unloading and re-loading if needed – otherwise waste is pushed up to the stockpile by the loader
- Priority is given to trucks departing the tip floor
- Departing trucks must proceed to the re-tarping area to restrain their load
- Trucks proceed to the outbound weigh bridge for weight out, where the weigh bridge officer completes the transaction so the truck can depart site